



**2 Bed
Flat
located in**



Flat, 174 Henleaze Road
Bristol
BS9 4NE



£1,550 Per month

Immaculately Presented 2-Bedroom Maisonette | Henleaze High Street | £1,550 pcm

Tucked above the buzz of one of Bristol's most sought-after high streets, this beautifully presented maisonette offers stylish, characterful living in the heart of Henleaze and is available now.

The standout master bedroom is a real talking point, a loft-style room with sloped ceilings, generous built-in eaves storage, and a fitted wardrobe. The second bedroom is a solid double, ideal for a guest room, home office, or flatmate. The large living room centres around a classic gas fireplace, giving the space real warmth and personality.

The modern kitchen is fully equipped with all white goods and features a charming built-in kitchen dresser, practical and with plenty of character.

The flat has a modern, fully tiled bathroom with shower over the bath and built-in jacuzzi jets.

The property comes partially furnished with a dining table, sofa, and curtains throughout so it's ready to move straight into.

Step out to a large rear decking area that catches the sun through the day - perfect for morning coffee or an evening wind-down, having this much outdoor space with a flat is a real bonus.



GROUND FLOOR
772 sq.ft. (71.7 sq.m.) approx.

1ST FLOOR
309 sq.ft. (28.7 sq.m.) approx.

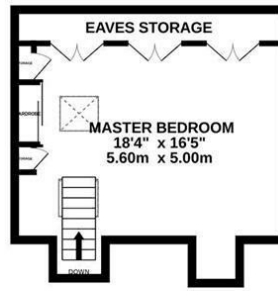

TOTAL FLOOR AREA : 1080 sq.ft. (100.3 sq.m.) approx.

Whilst every attempt has been made to ensure the accuracy of the floorplan contained here, measurements of doors, windows, rooms and any other items are approximate and no responsibility is taken for any error, omission or mis-statement. This plan is for illustrative purposes only and should be used as such by any prospective purchaser. The services, systems and appliances shown have not been tested and no guarantee as to their operability or efficiency can be given.
Made with Metropix 02023

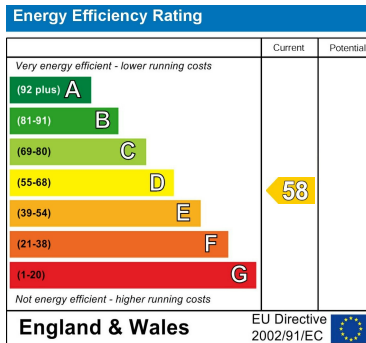

DIRECTIONS

CONTACT

Shore House Westbury Hill
Westbury-on Trym, Bristol
BS9 3AA

E: elliott.sherwood@frontdoorlettings.co.uk

T: 0117 457 8577

frontdoorlettings.co.uk

